

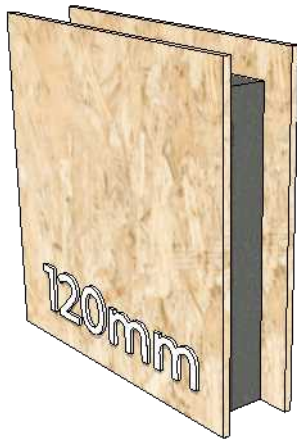

Overall SIP panel thickness:	96mm
OSB skins thickness:	11mm
EPS foam core thickness:	74mm
Rebate depth from OSB edges:	50mm
For use with timbers:	70x45mm
U-value	0.40
Price per SIP ex VAT:	£90.00
Price per SIP inc VAT:	£108.00



Overall SIP panel thickness:	120mm
OSB skins thickness:	11mm
EPS foam core thickness:	98mm
Rebate depth from OSB edges:	50mm
For use with timbers:	95x45mm
U-value	0.31
Price per SIP ex VAT:	£105.00
Price per SIP inc VAT:	£126.00

All panels are 1222mm x 2444mm.

Normal lead time from point of order is 4 weeks or sooner.

Delivery (please ask for price) or collection.



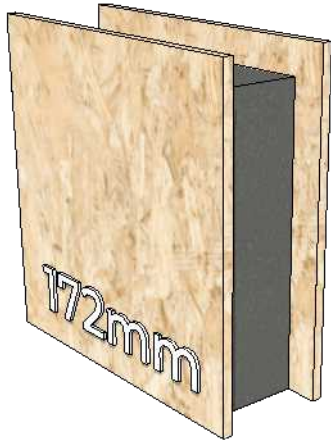

Overall SIP panel thickness:	172mm
OSB skins thickness:	11mm
EPS foam core thickness:	150mm
Rebate depth from OSB edges:	50mm
For use with timbers:	145x45mm
U-value	0.21
Price per SIP ex VAT:	£130.00
Price per SIP inc VAT:	£156.00



Overall SIP panel thickness:	222mm
OSB skins thickness:	11mm
EPS foam core thickness:	200mm
Rebate depth from OSB edges:	50mm
For use with timbers:	195x45mm
U-value	0.16
Price per SIP ex VAT:	£155.00
Price per SIP inc VAT:	£186.00

All panels are 1222mm x 2444mm.

Normal lead time from point of order is 4 weeks or sooner.

Delivery (please ask for price) or collection.

